

Pivot Chair Adapter, Light & Delivery Installation Instruction

Affordable Excellence + Designer Friendly®

Alert Symbols The safety notices associated with the following should be given special attention when they appear in maintenance, operating and emergency procedures in the guide.

⚠ CAUTION indicates that a particular procedure or precaution must be followed to avoid system irregularity or possible damage to the product.

❗ NOTE indicates special information to improve the ease of maintaining the product, or to clarify important information.

⚠ WARNING indicates that the personal safety of the patient, end user or technician could be compromised by disregarding the WARNING. Not following instructions may result in an injury.

⚠ CAUTION: Field modifications that alter the electrical and/or mechanical safety of Forest products conflict with agency construction file requirements and are not sanctioned by Forest.

❗ NOTE: Installation Verification: Refer to Operator's Guide or Service Manual on our web site at Forestdental.com: Perform all operations. If operations performing as intended installation complete. If operations not performing as intended, review steps in installation instructions to confirm correct installation or call Forest Technical Support at 800-423-3555.

Tools Required: 1/8", 3/16", 5/32" & 5/16" Allen Wrenches, 1/8", & 5/16" Allen Sockets with Torque Wrench, 15/16" Wrench, Flathead Screwdriver, Bubble Level, and Nitrile Gloves.

Chair Lift Stop/Spacer

⚠ CAUTION: A base down stop is not likely installed on your existing chair if a pivot light is being added aftermarket. One must be installed if the pivot light is attached to the bottom of the chair adapter. Failure to install the appropriate down stop may result in the motor pump cover being damaged when the chair is positioned full base down.

1. If stop was installed at Forest, proceed to page 2.
2. Remove the safety stop plate. (See Figure 1).
3. Install the appropriate base down stop over the lift cylinder rod. (See Figure 2).
4. Ensure the stop straddles the vent tube.
5. Reinstall the safety stop plate.

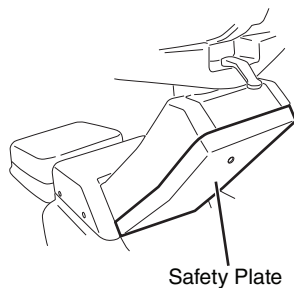

Figure 1: Safety plate.

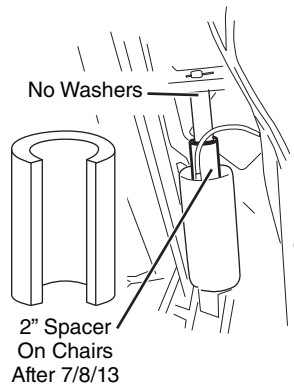
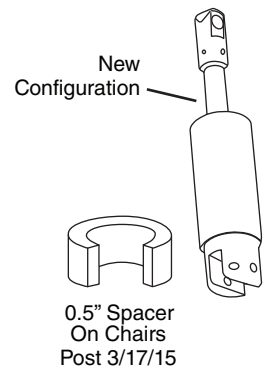
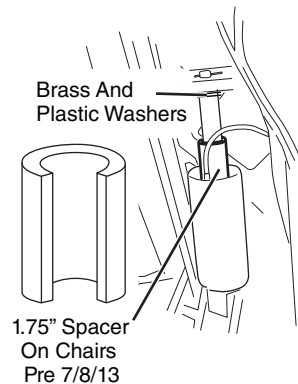

Figure 2: Base down spacer/stop.



Routing Suction Line

1. Remove covers. (See Figure 3).
2. Route and secure suction line. (See Figure 4).
3. Make appropriate connection at utility center.

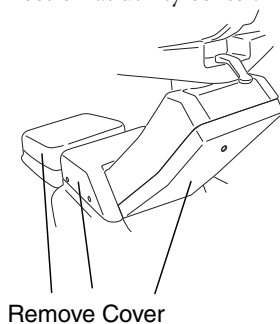

Figure 3: Remove covers.

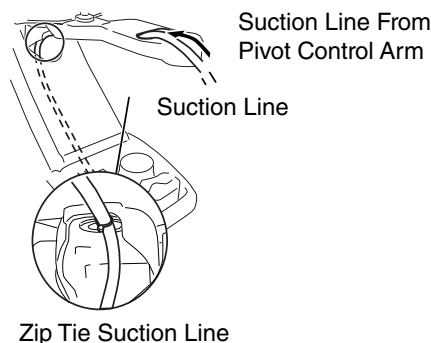

Figure 4: Pivot control arm suction line.

⚠ CAUTION: Ensure bearings stack components are placed in order shown in Figure 1.

! NOTE: Single replacement bearing kit (1115-396), (2) kits required if pivot chair is equipped with light and control head posts.

1. Attach bolt retention spacer with 2 cap screws provided, align top and bottom spacer for set screw access on side of adapter. (See Figure 1).
2. Install bearing assemblies as shown and secure stack with button head screw bolt (top and bottom).
3. Apply 30 ft - lb of torque to button head screw.
4. After checking pivot arm for swing, tighten set screw in bolt retention spacer to 3 ft lb.
5. Match and connect tubings/wires. Trim tubings to proper length. (See Figure 2).
6. Tidy up connections. Pull sheathing cover and tug. (See Figure 3).
7. Determine if pivot arm(s) is level. (See Figure 4).
8. If required, loosen (2) 15/16" mounting bolts (just enough to free setscrews). (See Figure 4).
9. Adjust setscrews to level arms and tighten mounting bolts. Verify that all arm(s) is level.

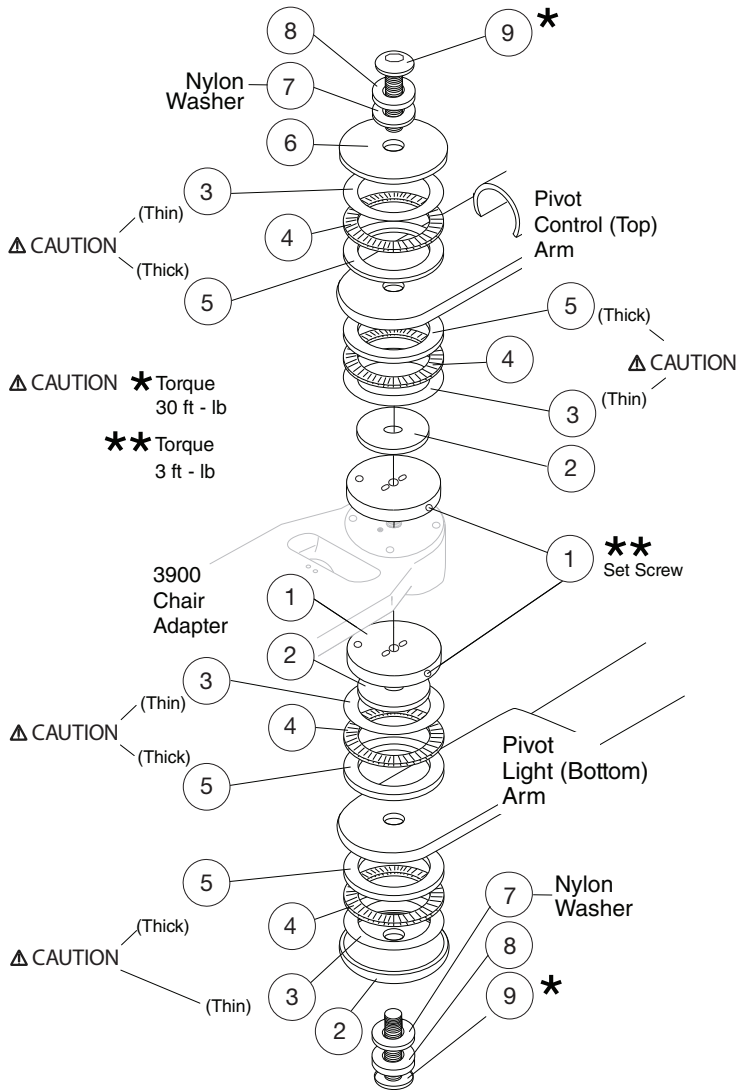
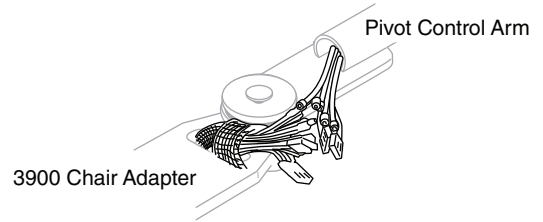

Figure 1: Front pivot bearings assembly.



! Note: See page 1 for suction line routing.

Figure 2: Tubings/wires connection.

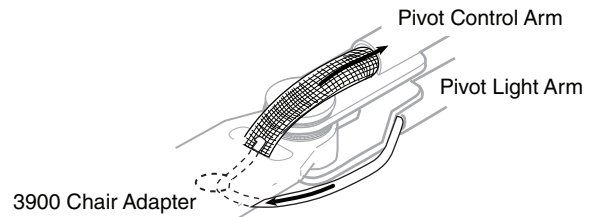

Figure 3: Cover up tubings/wires.

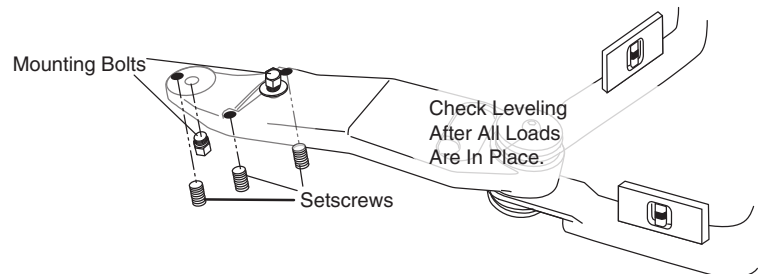

Figure 4: Level arm(s).

F Forest Dental Products Inc.  Address 6200 ne cherry drive hillsboro oregon 97124 • USA

Phone 800 .423 .3555 • 503 .640 .3012 | Fax 503 .693 .9715 | Digital sales@forestdental.com • forestdental.com

Authorized Representative: Emergo Europe • prinsessegracht 20 | 2514 ap the hague | the netherlands **EC REP**

CE Conformity Assessment:
Medical Device Directive Annex VII

6.19.17 • 0097-015 • Rev. A • 2 of 2