

Rear Pivot Mount Installation Instruction

Routing Drain/Suction Line

1. Remove covers. (See Figure 1).
2. Route and secure tubings together with zip tie.
3. Make appropriate connection at utility center.

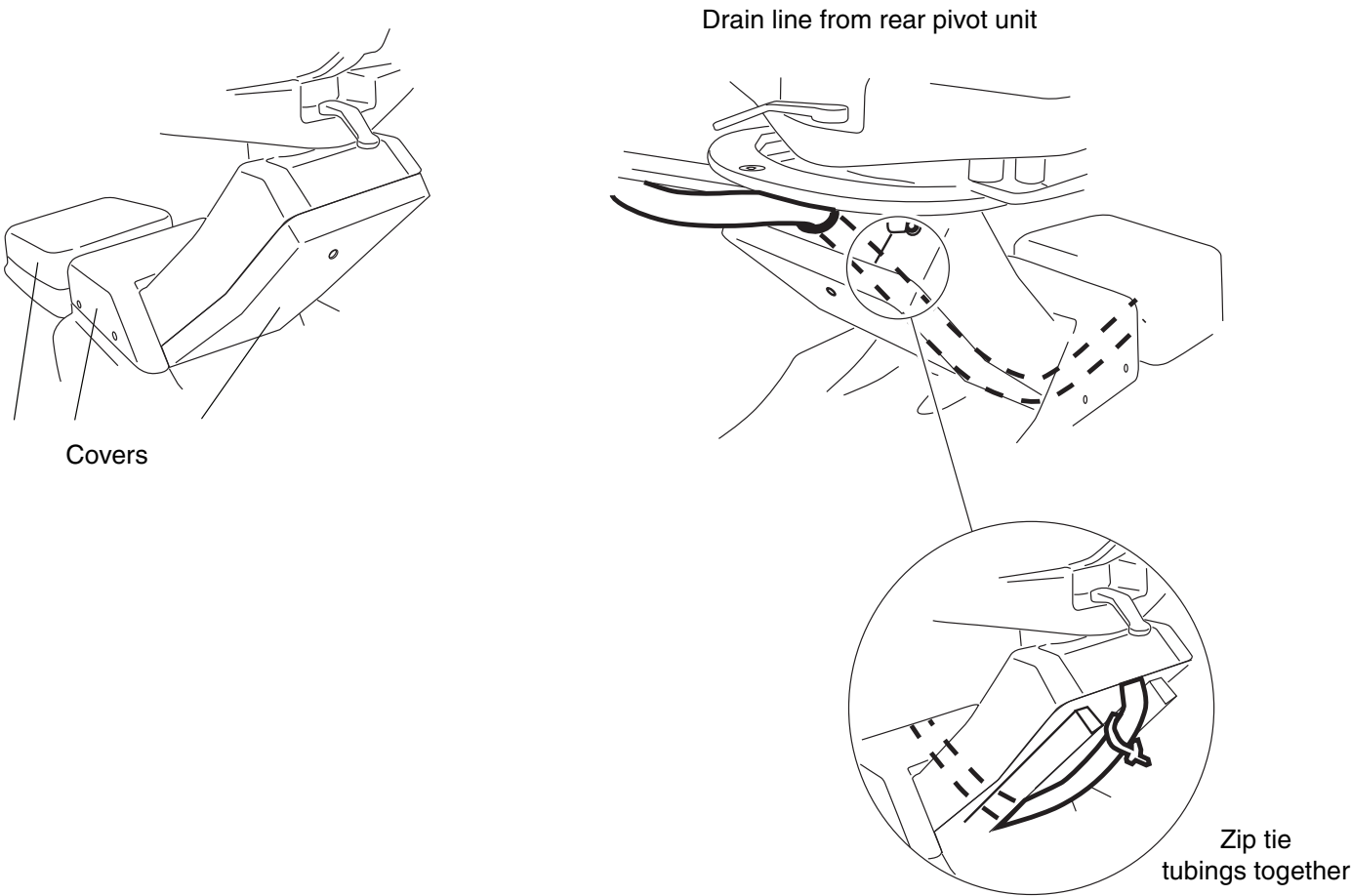



Figure 1: Remove covers.

Figure 2: Rear unit drain/suction line.

 Forest Dental Products Inc.  Address 6200 ne cherry drive hillsboro oregon 97124 • USA

Phone 800 . 423 . 3555 • 503 . 640 . 3012 | Fax 503 . 693 . 9715 | Digital sales@forestdental.com • forestdental.com





Authorized Representative: Emergo Europe • prinsessegracht 20 | 2514 ap the Hague | the Netherlands 

 Conformity Assessment: 0459 Medical Device Directive Annex V

12.12.17 • 0097-305 • Rev. Q • 4 of 4

Affordable Excellence + Designer Friendly®

Alert Symbols The safety notices associated with the following should be given special attention when they appear in maintenance, operating and emergency procedures in the guide.

-  CAUTION indicates that a particular procedure or precaution must be followed to avoid system irregularity or possible damage to the product.
-  NOTE indicates special information to improve the ease of maintaining the product, or to clarify important information.
-  WARNING indicates that the personal safety of the patient, end user or technician could be compromised by disregarding the WARNING. Not following instructions may result in an injury.
-  CAUTION: Field modifications that alter the electrical and/or mechanical safety of Forest products conflict with agency construction file requirements and are not sanctioned by Forest.
-  NOTE: Installation Verification: Refer to Operator's Guide or Service Manual on our web site at Forestdental.com: Perform all operations. If operations performing as intended installation complete. If operations not performing as intended, review steps in installation instructions to confirm correct installation or call Forest Technical Support at 800-423-3555.

Rear Pivot Mount Kit, 3900 Chair

Tools Required: 1/8", 5/32", 3/16", 3/32" & 5/16", 3mm, 8mm, and 10mm, Allen Wrenches, 1/8", 5/16" Allen Sockets with Torque Wrench, 3/4", 9/16" & 15/16" Wrench, Flathead Screwdriver, and Nitrile Gloves.

-  NOTE: Chairs purchased before July of 2014 contain metric screws, all chairs purchased after this date contain standard screws. This kit contains a metric and standard nut and bolt set to accommodate either chair. Please check to make sure that you are using the correct tools and hardware for your chair before proceeding. If rear pivot is already installed, proceed to page 3.

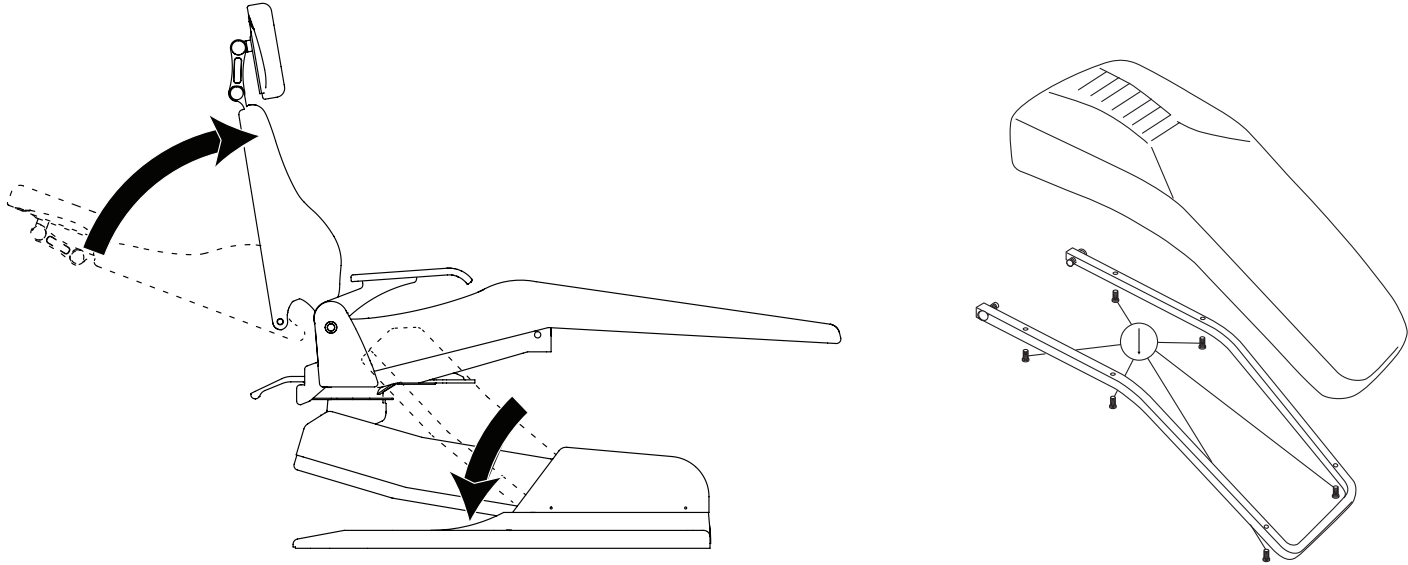

1. Position the chair's back in the fully up position, and the base in the fully down position.
2. Remove the 6 screws holding the upholstery in place (Phillips screwdriver.) Set upholstery aside.

Lift Cover Plate Installation

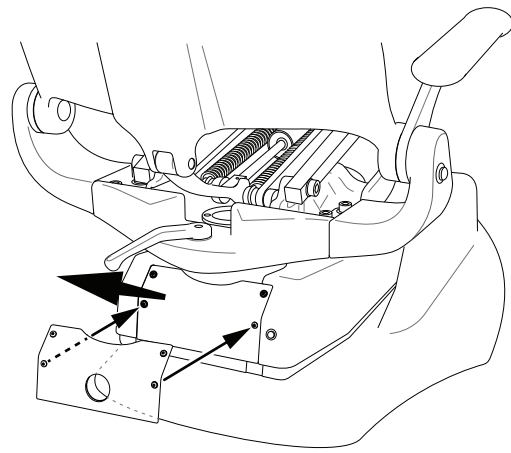

1. Remove existing lift cover plate from chair (1/8" or 3mm Hex)
2. Use pre-existing screws to install the new plate cover that contains the umbilical routing hole.

Rear Pivot Mount Setup

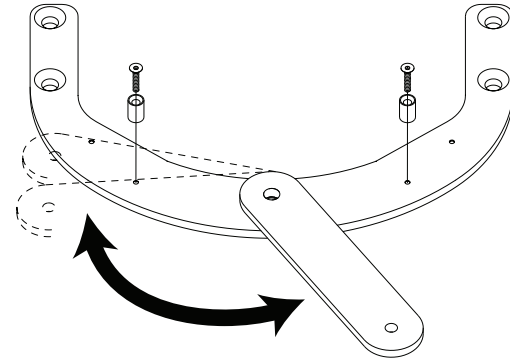

1. Install rear pivot bumpers on the mounting plate using the screws provided (5/32" Hex.) Choose hole location based on the desired limits of the link arm that will be attached.

Rear Pivot Delivery Bearing Assembly - Assistant's

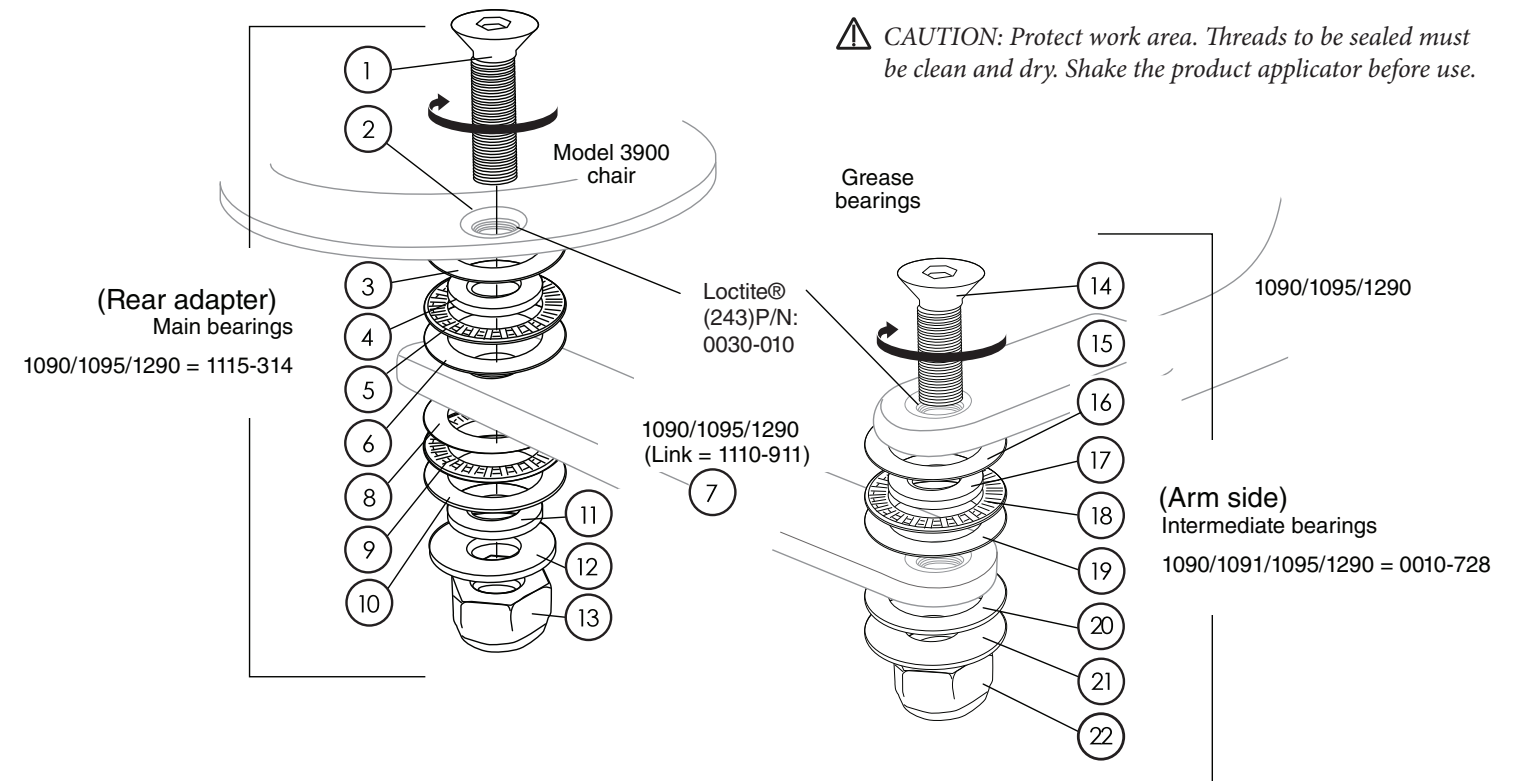

Rear Pivot Mount Installation

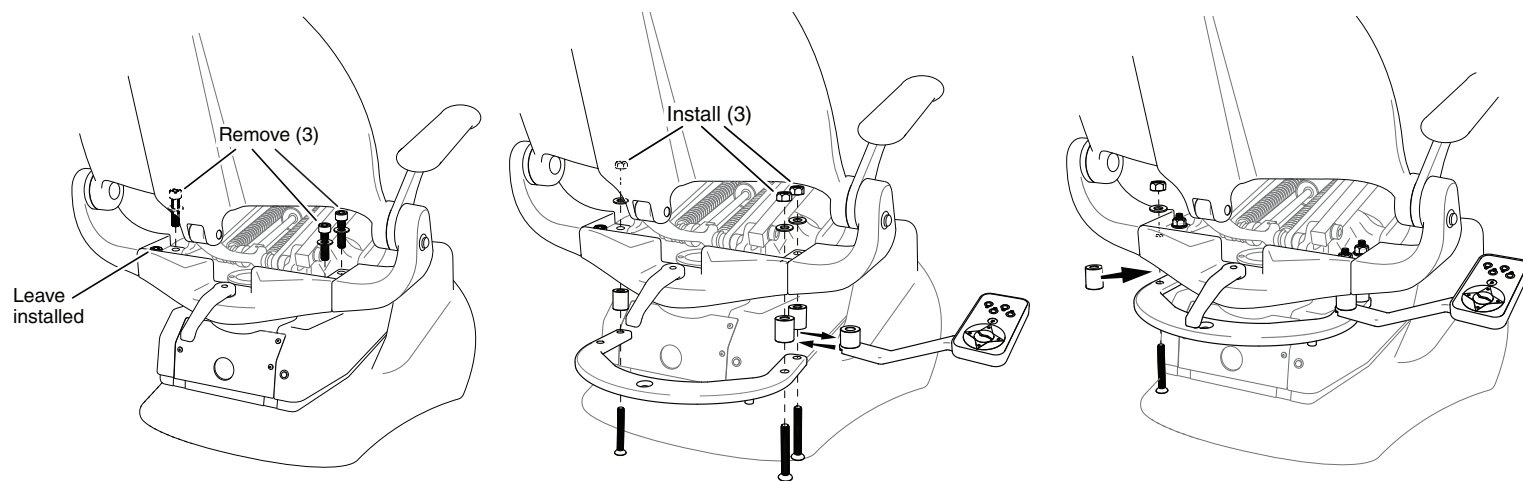

1. Remove 3 shoulder bolts as shown (3/8" or 10mm hex.) If a chair mounted touchpad is installed, remove it during this step.
2. Install mounting plate and spacers with nuts and bolts provided. (5/16" hex & 3/4" socket or 8mm hex & 19mm socket.) If re/installing a chair mounted touchpad, insert the touchpad mount assembly in place of the provided spacer.
3. Remove remaining shoulder bolt. Insert spacer and secure with nut and bolt (5/16" hex & 3/4" socket or 8mm hex & 19mm socket.)

Rear Pivot Delivery Bearing Assembly - Duo Control and Cuspidors

